

esquire



SOUGHT AFTER LOCATION

OPEN PLAN LOUNGE AND FAMILY ROOM

SPACIOUS ROOM SIZES THROUGHOUT

THREE BEDROOMS

OPEN PLAN KITCHEN/DINER

GROUND FLOOR SHOWER ROOMS



Chatsworth Road
Luton, LU4 8AS

Offers in the Region
Of £335,000

Entrance Hallway

Door to front aspect, radiator.

Lounge and Family Room 26' 11" x 10' 6" (8.2m x 3.2m)

Double glazed window to front and rear aspect, radiator.

Kitchen/Diner 23' 4" x 8' 10" (7.1m x 2.7m)

Double glazed window and door to side aspect. Kitchen fitted with a range of wall and base units with roll top work surfaces, sink drainer, plumbing for washing machine, space for fridge freezer and cooker, wall mounted combination boiler, under stairs storage cupboard.

Shower Room

Double glazed window to rear aspect, low level w.c. wash hand basin, sports pressure shower, fully tiled.

First Floor Landing

Loft access

Master bedroom 15' 5" x 14' 1" (4.7m x 4.3m)

Double glazed window to front aspect, radiator.

Bedroom Two 12' 6" x 9' 6" (3.8m x 2.9m)

Double glazed window to rear aspect, radiator.

Bedroom Three 9' 2" x 11' 2" (2.8m x 3.4m)

Double glazed window to rear aspect, radiator.

Family Bathroom

Double glazed window to side aspect, radiator, roll top bath, low level w.c. wash hand basin.

Front garden

Path to front

Rear Garden

Paved

Outhouse

Pitched roof with power and light

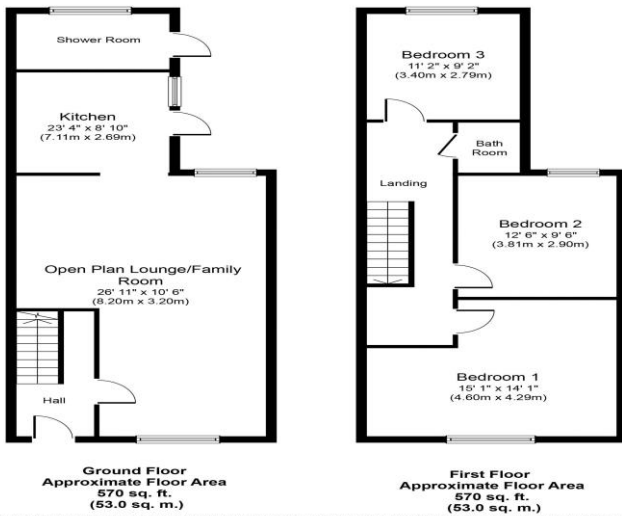

Whilst every effort has been made to ensure the accuracy of the floor plan contained here, measurements of doors, windows, rooms and any other items are approximate and no responsibility is taken for any error, omission, or mis-statement. This plan is for illustrative purposes only and should be used as such by any prospective purchaser or tenant. The services, systems and appliances shown have not been tested and no guarantee as to their operability or efficiency can be given.

